

**APPROVED**  
City of Calabasas • Planning Dept.  
Date: 6-17-2021 File: SGNP-2021-001 and MSCP-2021-003  
By:   
Notes: Approved Sign Program

# RONDELL h o t e l

MASTER SIGN PROGRAM  
Rondell St. | Calabasas, CA



JUNE 3, 2021



# Table of Contents

**Title Page ..... 1**

**Table of Contents ..... 2**

**Purpose, Maintenance, & Design Criteria ..... 3**

**Site Map ..... 4**

**Proposed: S1 – 10” Cambria Hotel Bronze Letters ..... 5**

**Proposed: S2 – 8’0” Monument ..... 6**

**SIGN COMPANY**

AGI  
2655 International Parkway,  
Virginia Beach, VA 23542  
(800) 877-7868  
#

**OWNER**

Rondell Hotel, LLC  
22603 Pacific Coast Highway, #761  
Malibu, CA 90265  
(310) 456-2600

## **Purpose**

The purpose of this Master Sign Program is to provide a uniform criteria for this hotel, and to provide consistent standards for signage for existing and future tenants. These standards will comply with the Uniform Building Code and the City of Calabasas sign code.

## **Maintenance**

Signs in the Cambria Hotel Calabasas-Malibu will be maintained in an “As New” condition. Landlord and Landlord’s Agents will periodically inspect conditions. Required maintenance will be necessary under these conditions:

1. Material aging - Fading, cracking, or peeling materials must be replaced or refinished.
2. Illumination - Outage, flickering or dimming illumination must be serviced.
3. Damage - Any signs damaged by persons or natural events must be repaired. All repairs will be the responsibility of the tenant.

## **Design Criteria**

Tenants and sign contractors will use all means to protect tenants and Landlord from liability, in addition to means outlined in submittal drawings and this Program. This includes all methods of installation and repair. Upmost attention to safety is requested and required. All electrical signage must conform to UL standards and be UL listed, and be installed by an appropriately licensed electrical contractor. All wires and electrical supplies shall be fully concealed, exposed wiring and raceways are not permitted. If the hotel changes brands at any point in the future, their signage is to follow the Master Sign Program herein. A new sign program shall be required for new signage not included in this sign program.

### **SIGN COMPANY**

AGI  
2655 International Parkway,  
Virginia Beach, VA 23542  
(800) 877-7868  
#

### **OWNER**

Rondell Hotel, LLC  
22603 Pacific Coast Highway, #761  
Malibu, CA 90265  
(310) 456-2600

# SITE MAP

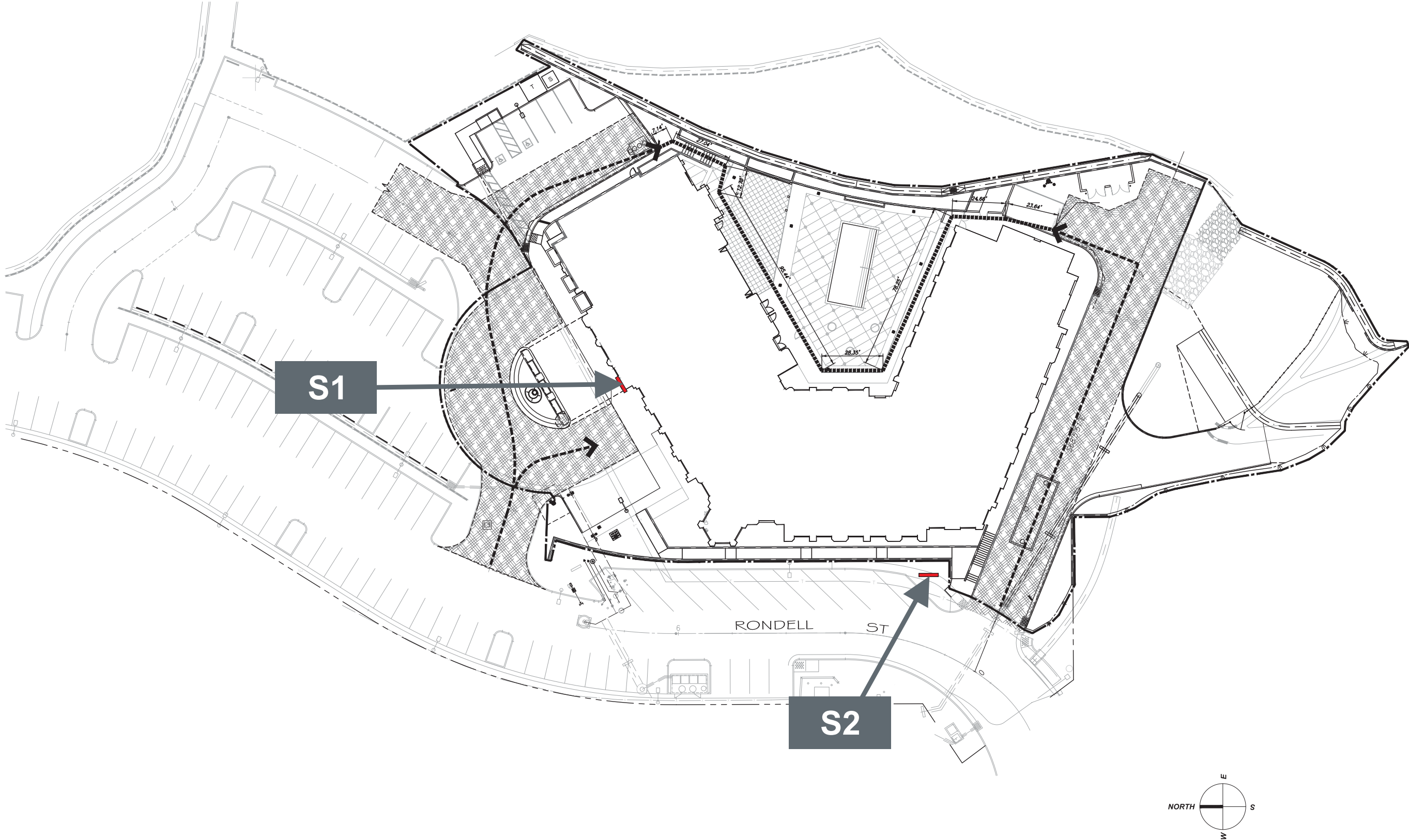

**S1**

**S2**



ADDRESS: Rondell St. | Calabasas, CA  
 \_\_\_\_\_  
 \_\_\_\_\_  
 DRAWN BY: CA  
 \_\_\_\_\_

DATE: 12/27/19  
 REVISION: 07/13/20 | 10/26/20  
 05/14/21 | 06/03/21  
 PAGE: 2

This document is the sole property of AGI, and all design, manufacturing, reproduction, use and sale rights regarding the same are expressly forbidden. It is submitted under a confidential relationship, for a special purpose, and the recipient, by accepting this document, assumes the custody and agrees that this document will not be copied or reproduced in whole or in part, nor its contents revealed in any manner or to any person except for the purpose for which it was tendered, nor any special features peculiar to this design be incorporated in other projects.



**PROPOSED: S1 - 10" CAMBRIA HOTEL BRONZE LETTERS**



**SIGN COPY DETAILS:**  
 Sign Type: Building Mounted  
 Description: Channel letter to be individually Mounted, 3 inch deep letters with a 1-inch Offset from wall  
 Material: Aluminum  
 Color: Bronze  
 Illumination: Halo  
 Max Height: 10 inches in total height  
 Max Length: 42 Inches  
 Max Size: 3 square feet  
 Location: Next to main Entrance

**PROPOSED: S2 - 8'0" MONUMENT**

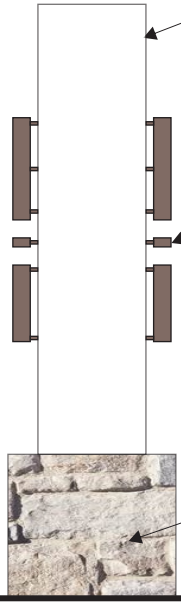
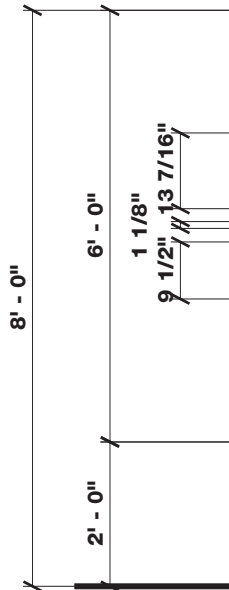
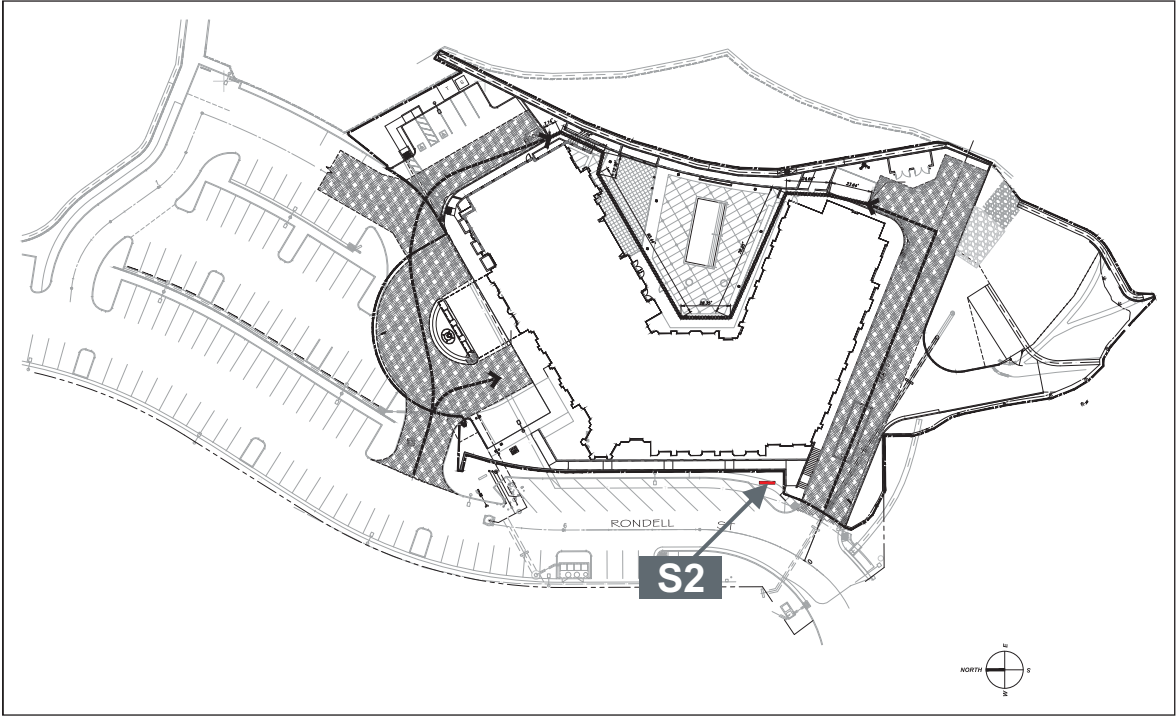
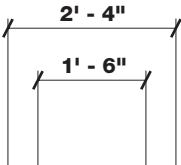
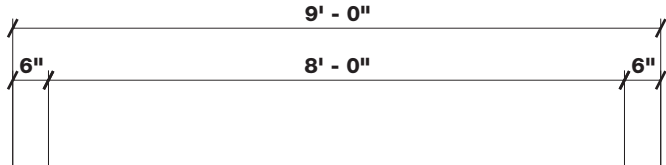

Stucco Smooth Finish to match building color

Halo Illuminated Aluminum Letters Painted Bronze

Limestone Grand Banks Eldorado Stone to match adjacent wall

**SIGN COPY DETAILS:**  
 Description: Individually Mounted, 3 inch deep letters with a 1-inch Offset from wall  
 Material: Aluminum  
 Color: Bronze  
 Illumination: Halo  
 Comment: Shall not project over monument

ELEVATION: CUSTOM D/F MONUMENT  
 SCALE: 3/8" = 1'-0"  
 100 Sq.Ft.

SIDEVIEW